

# 1. Safety and responsibility



## 1.1 Safety

- Always read these installation instructions before installing this Somfy product.
- This Somfy product must be installed by a professional motorisation installer, for whom these instructions are intended.
- Never begin installing without first checking the compatibility of this product with the associated equipment and accessories.
- These instructions describe how to install, commission and operate this product.
- Moreover, the installer must comply with current standards and legislation in the country in which the product is being installed and inform his customers of the operating and maintenance conditions for the product.
- Any usage outside of applications defined by Somfy constitutes non-compliance, and is therefore not covered by the warranty.

## 1.2 Declaration of conformity

SOMFY hereby declares that this product conforms to the essential requirements and other relevant provisions of Directive 1995/5/CE. A Declaration of Conformity is available at [www.somfy.com/ce](http://www.somfy.com/ce).



## 1.3 Operating conditions

- Do not install the product in rain or in bad weather conditions.
- Never connect several motors to a Mod/Var Receiver RTS.
- Never connect several Mod/Var Receiver RTS to a single motor.
- The product should NEVER be installed close to metal surfaces.
- Check the radio range before securing the product. The radio range is limited by the radio appliance control standards.
- **Caution!** The use of a radio appliance (e.g. a set of Hi-Fi radio headphones) operating on the same frequency might cause interference and hinder the product's performance.
- The building in which the product is used might reduce the radio range.

This range is:

- X = 200 m in an acoustic free field.
- Y = 20 m through 2 concrete walls.

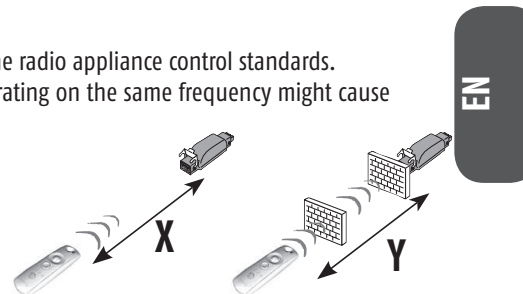

# 2. Installation

## 2.1 Installation recommendations

Minimum distance (X) between a Mod/Var Receiver RTS and the ground: X = 150 cm

Minimum distance (Y) between a Mod/Var receiver RTS and a radio control point:

Y = 30 cm

Minimum distance (Z) between two Mod/Var Receiver RTS: Z = 20 cm.

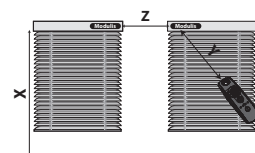

## 2.2 Fitting the Mod/Var Receiver RTS (Hirschmann plugs)

Caution: The Mod/Var Receiver RTS must be installed protected from rain and bad weather conditions, out of sight and out of reach.

- Switch off the mains power supply.
- Disconnect the motor cable connector from the power supply cable connector.
- Connect the Mod/Var Receiver RTS between the motor cable and the supply cable.
- After checking that the two fixings are properly engaged, lock the clips to the tabs.

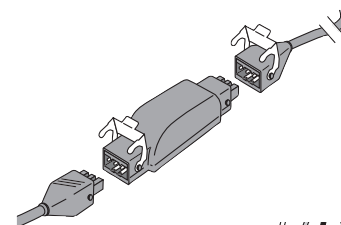

## 2.3 Fitting the Mod/Var Receiver RTS (cables)

Caution: The Mod/Var Receiver RTS must be installed protected from rain and bad weather conditions, out of sight and out of reach.

- Switch off the mains power supply.
- Disconnect the motor cable from the power supply cable.
- Connect the Mod/Var Receiver RTS to the motor cable and the power supply cable using terminal blocks.

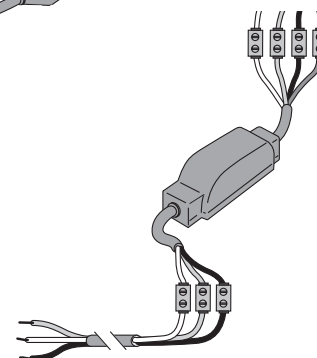

## 3. Commissioning

### 3.1 Commissioning

To set the end limits of the motor, it is necessary to temporarily allocate an RTS remote control to the Mod/Var receiver:

- Install the Mod/Var in the rail or outside the headrail.
- Connect the power supply.
- Briefly press the ▲+▼ buttons on an RTS remote control: the blind will make a quick up and down movement to confirm it can be controlled temporarily by this RTS remote control.
- Use the ▲ and ▼ buttons on the RTS remote control to set the motor end limits (see motor instructions).

After having set the motor end limits, it is possible to:

- **pair the first RTS remote control** (factory programming), see 3.2.
- **perform advanced settings**, see 3.3.

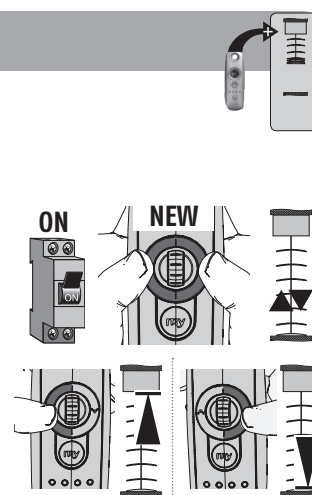

### 3.2 Pairing the first RTS remote control

After carrying out step 3.1, briefly press (0.5 seconds) the "PROG" button on the RTS remote control (see instructions for the remote control): the blind will confirm the RTS remote control is paired.

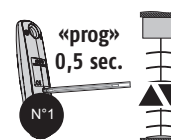

### 3.3 Advanced settings

It is possible to perform the following adjustments, without having paired the first RTS remote control (for example if it must be paired on-site):

Re-setting or clearing the "My" position» .....	chap. 8
Setting the "sun disappearing" position ».....	chap. 9
Setting the RTS remote control scrollwheel .....	chap. 10

## 4. Adding an RTS remote control or sensor

**This procedure can only be used after carrying out step 3.2.**

- Press the "PROG" button on RTS remote control No. 1 for 2 seconds (already paired): the blind will confirm, the Mod/Var receiver is ready to pair with a new RTS remote control or an RTS sensor.
- Briefly press (0.5 seconds) the "PROG" button of the product to add: the blind will feedback, the new product is paired.

Note: it is possible to pair a maximum of 12 RTS remote controls and 3 RTS sensors. Beyond this, the new products are not registered.

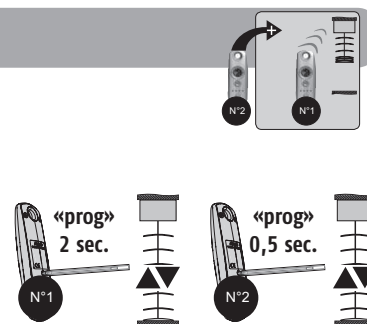

## 5. Removing an RTS remote control or sensor

**This procedure can only be applied if at least 2 RTS remote controls (or 1 remote control plus an RTS sensor) are already paired.**

- Press the "PROG" button on RTS remote control No. 1 for 2 seconds (to keep down): the blinds will confirm that the Mod/Var receiver is ready to clear of the paired products.
- Briefly press (0.5 seconds) the "PROG" button for the product function to be removed (RTS Mod/Var remote control, "wind" sensor, "wind/sun" sensor, "sun" sensor): the blind will feedback, the product is no longer paired.

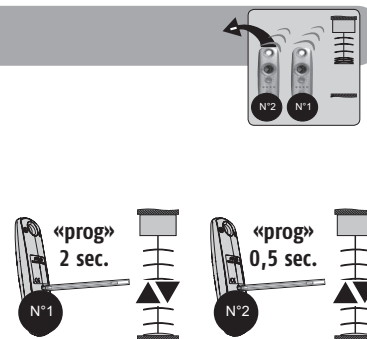

## 6. Replacing the RTS remote controls (emergency procedure)

This procedure can be carried out without losing the current settings, as well as the RTS sensors already paired, in case of loss or deterioration of the RTS remote controls already paired.

- Perform a double shutdown of the power supply (OFF 2 seconds – ON 5 seconds – OFF 2 seconds – ON): the blind goes down for 5 seconds, the Mod/Var receiver has cleared from its memory the products already paired, except the RTS sensors, and is ready to pair a new RTS remote control.
- Briefly press (0.5 seconds) the “PROG” button on the RTS remote control: the blinds will confirm, the new RTS remote control is paired.

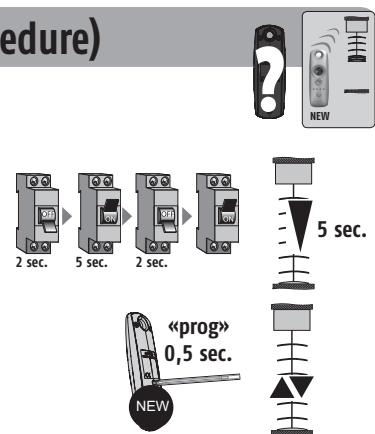

## 7. Returning to factory settings

This procedure clears all the settings made previously to return to the factory configuration.

- Carry out a **double switch off of the power supply** (OFF 2 seconds – ON 5 seconds – OFF 2 seconds – ON): the blinds go down for 5 seconds, the Mod/Var receiver has cleared the products already paired from its memory.
- Press the “PROG” button on a RTS remote control for 7 seconds: after 2 seconds, the blind perform an initial confirmation, then after another 7 seconds the specific settings are cleared.

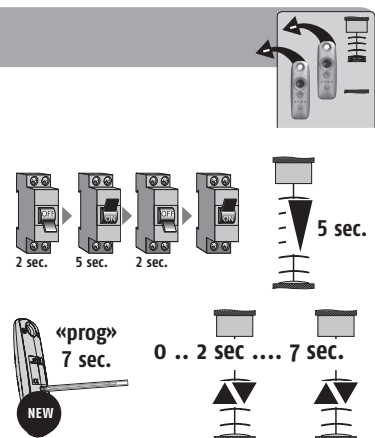

## 8. “My” position

### 8.1 Re-setting the “My” position

The “My” position is pre-set in the factory, it corresponds to the “slats lowered, sun protection” position. To modify this position (use a paired or temporarily allocated RTS remote control if step 3.2 has not been applied):

- Press the button: the blind lowers to the bottom position, slats closed.
- Press the buttons + for 2 seconds: the slats will tilt to the programmed “My” position.
- Position the slats as required, using the scrollwheel of the RTS remote control to increase or decrease the slat angle.

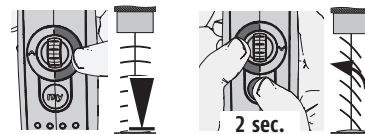

### 8.2 Testing the “My” position (optional step)

Press the button:

- If the slats are in the “My” position, they will tilt to the closed position.
- If the slats are in the closed position, they will tilt to the “My” position.

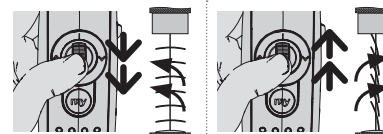

### 8.3 Storing the “My” position

In the “My” position, press the button for 5 seconds: the blinds will confirm, the “My” position is stored.

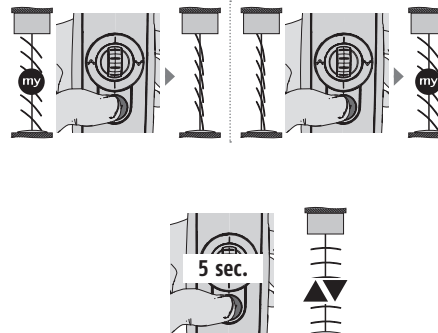



## 8.4 Clearing the "My" position

To clear the "My" position:

- Press the button on a RTS remote control that is paired (or temporarily allocated if step 3.2 has not been applied): the blind lowers to the bottom position, slats closed.
- Press the buttons + for 2 seconds: the slats will tilt to the programmed "My" position.
- Press the buttons + for 5 seconds: the "My" position is cleared (the button will only operate as a "STOP" button).

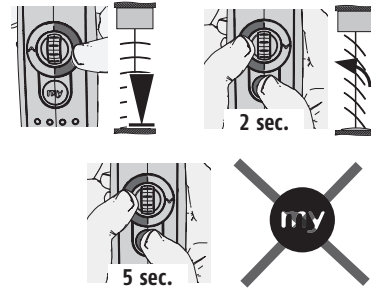

## 9. Sun disappearing



### 9.1 Re-Setting the "sun disappearing" position

**Note:** It is not possible to re-set the "sun disappearing" position if the "My" position has been cleared (step 8.4).

The "sun disappearing" position is pre-set at the factory but not activated, it corresponds to the "slats raised" position.

To activate or modify this position (use a paired or temporarily allocated RTS remote control if step 3.2 has not been applied):

- With the blind stopped, briefly press the button for 0.5 seconds: the blind lowers, then the slats tilt to the "My" position.
- Press the buttons + for 2 seconds: the blind will go up to the "sun disappearing" position.
- Position the slats as required, using the scrollwheel of a paired or temporarily allocated RTS remote control to increase or decrease the slat angle.

Telis Mod/Var Soliris remote control

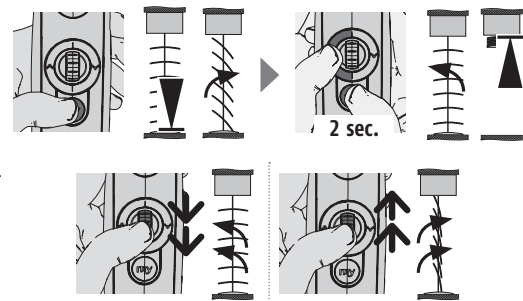

### 9.2 Testing the "sun disappearing" setting (optional step)

Press the button on a RTS remote control that is paired (or temporarily allocated if step 3.2 has not been carried out):

- If the slats are in the "sun disappearing" position, the blind will go down (if necessary) and the slats will tilt to the "My" position.
- If the slats are in the "My" position, they will tilt and the blind will go up (if necessary) to the "sun disappearing" position.

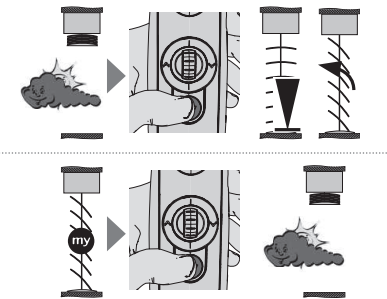

### 9.3 Storing the "sun disappearing" position

In the "sun disappearing" position, press the button of a RTS remote control that is paired for 5 seconds (or provisionally allocated if step 3.2 has not been carried out): the blind will confirm, the "sun disappearing" position is stored.

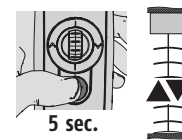

### 9.4 Clearing the "sun disappearing" position

To clear the "sun disappearing" position, carry out the following procedure (use a paired RTS remote control or one that is temporarily allocated if step 3.2 has not been carried out):

- Press the button: the blind goes down, then the slats tilt to the "My" position.
- Press the buttons + for 2 seconds: the blind will go up to the "sun disappearing" position.

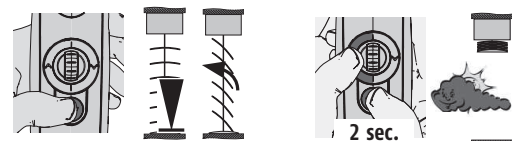

(CONTINUED ON NEXT PAGE)



- Press the buttons **my** + **▲** for 5 seconds: the blind will confirm, the “sun disappearing” position is cleared. In normal operation, when the sun disappears, the blind will move to the top end limit position.

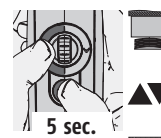

### 9.5 No movement when the sun disappears (privacy position)

It is possible to temporarily deactivate the “sun disappearing” position (use a paired RTS remote control or one that is temporarily allocated if step 3.2 has not been carried out):

- Press the **my** button: the blind lowers, then the slats tilt to the “My” position.
- Press the buttons **my** + **▼** for 5 seconds: the blind will confirm, it will not change position when the sun disappears.

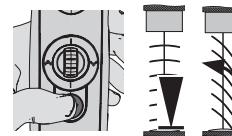

Note: to use the “sun disappearing” position again, the same procedure must be carried out.

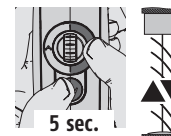

## 10. Setting ergonomics

### 10.1 Setting the tilting angle of the slats with to the scrollwheel of a Mod/Var RTS remote control

- Press the **▼** button. When the blind is in the lowered position, briefly press the **my** + **▲** + **▼** buttons: the blind will confirm.
- Press **▲** to **increase** the tilting angle of the slats corresponding to the scrollwheel, or press **▼** to **reduce** this angle.
- To check the tilting angle of the slats, starting with the closed slats, briefly press the **my** button: each time it is pressed, the slats will tilt according to the corresponding value of one notch.
- To validate the tilting angle of the slats, press the **my** button for 5 seconds: the blind will feedback.

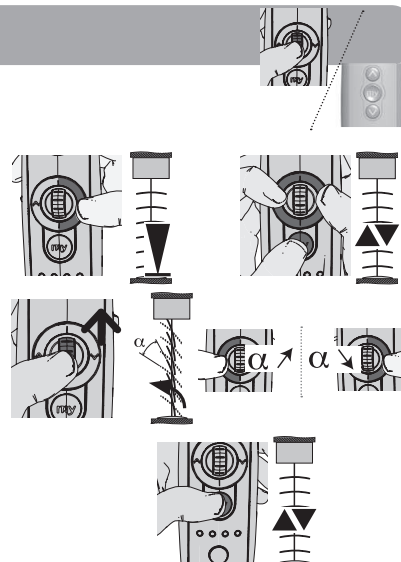

### 10.2 Using a Telis RTS remote control

By default, the Mod/Var receiver is **delivered in “US” mode**. When Telis RTS remote control is being used:

- Briefly pressing (< 0.5 seconds) on the **▲** or **▼** button of the Telis RTS remote control will cause the blind to go up or go down to the end limit.
- Pressing and holding (> 2 seconds) the **▲** or **▼** button of the Telis RTS remote control will cause the slats to tilt.

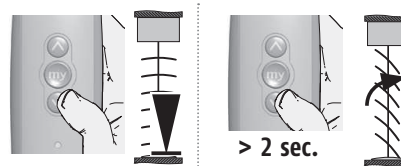

### 10.3 “Europe” mode

Using a remote control in “Europe” mode:

- Briefly pressing (< 0.5 seconds) on the **▲** or **▼** button of the Telis RTS remote control will cause the slats to tilt.
- Pressing and holding (> 2 seconds) the **▲** or **▼** button of the Telis RTS remote control will cause the blind to raise or lower to the end limit.

To switch between the “US” mode and “Europe” mode, carry out the **following procedure just after powering on the Mod/Var receiver** (this function is activated for 30 seconds after powering on):

- Press the **my** button on the Telis RTS remote control for 5 seconds, the blind will confirm to indicate the change of mode.

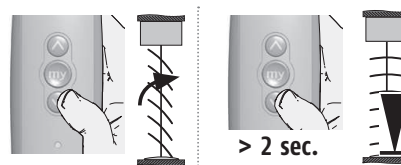

## 11. Wind/sun functions

### 11.1 When the wind comes up

As soon as a wind sensor is paired, the automatic function operates as follows: 2 seconds after the windspeed has exceeded the threshold of the anemometer, the blind goes up to the top end limit position. **Any move down requests are not acknowledged when the windspeed has not fallen below the anemometer threshold.**



2 sec.



### 11.2 When the wind dies down

When the windspeed falls below the anemometer threshold, the blind can go down after a delay of:

- 30 seconds, in the case of a manual request (✓ or my).
- 12 minutes for the sun function to reactivate.

Note: in "Demo" mode, the delay is 3 seconds for a manual request and 12 seconds for automatic action according to the sunlight.



30 sec.



### 11.3 Sun appearing

As soon as a sun sensor is paired, the automatic function operates as follows: 2 minutes after luminosity is greater than the threshold of the "sun" sensor, the blind goes down to the bottom end limit, and the slats tilt to the "My" position. If the "My" position has been cleared (see 8.4), the blind will remain in the bottom end limit.

Note: in "Demo" mode, the delay is 10 seconds



12 min.



### 11.4 Sun disappearing

Several cases may arise (the different delays have been defined to avoid continuous movement caused by passing cloud). For example, if the luminosity has been above the "sun" sensor threshold for more than 90 minutes, the blind will act 10 minutes after the sun has disappeared:



2 min.

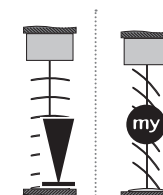

Time for which the luminosity has exceeded the "sun" sensor threshold	Delay before the blind reacts after the sun has disappeared
> 90 minutes	10 minutes
60 / 90 minutes	15 minutes
30 / 60 minutes	20 minutes
< 30 minutes	25 minutes
Demonstration	12 seconds

The reaction of the blind may be:

- By default the blind raises to the top end limit position.
- If the "sun disappearing" position has been activated, the blind will assume this position.
- If the "sun disappearing" position has been cleared, the blind will go up to the top end limit.
- If option 9.5 has been selected, the blind will not react when the sun disappears.

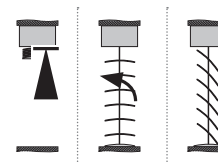

### 11.5 Manual control

The sun function is temporarily deactivated when a manual request is made ("up", "down", "my" or scrollwheel used).

The "sun" function will resume operation:

- \* with the next change in status of the sun (appears or disappears).
- \* when the automatic function is activated with a Telis Mod/Var Soliris remote control.

### 11.6 Demo mode

The "demo" mode makes it possible to check the operation of the "wind" and "sun" sensors, by reducing the delay times: see the instructions for the sensor concerned to change to demo mode.

## 12. Adjusting the end limits of J4WT motors

- Connect the Mod/Var Receiver RTS to the J4 WT motor.
- Switch on power supply
- After learning in the remote control push ▲ or ▼ button.  
It recognizes automatically if the motor is mechanical or electronical.  
The learning in of the remote control is described in section 3 „Commissioning” or in the manual.

### 12.1 Commissioning the programming mode

- The screen must be positioned between the upper and lower end limit.
- Press both buttons ▲+▼ simultaneously for at least 7 seconds.  
=> Motor turns briefly in Up direction.

#### 12.1.1 Adjusting the upper end limit

- Press Up button ▲ .  
=> Motor turns, stops briefly, then continues in the Up direction.  
The stop indicates the programming mode.  
Press my after drapes have reached the desired upper end limit.  
For fine adjustment of the upper end limit press ▲ and my buttons alternately.
- **Exit the programming mode without saving end position:**  
Push ▲+▼ button at the same time for 3 seconds.
- **Exit the programming mode with saving end position:**  
Press Down button ▼ for storing the end limit and leaving the programming mode.  
=> Motor turns, stops briefly, then continues to turn in the Down direction.  
The stop indicates that you have left the programming mode.

#### 12.1.2 Adjusting the lower end limit

- Press the Down button ▼ .  
=> Motor turns, stops briefly, then continues to turn in the Down direction.  
The stop indicates the programming mode.  
Press my after drapes have reached the desired lower end limit.  
For fine adjustment of the lower end limit press ▼ and my buttons alternately.
- **Exit the programming mode without saving end position:**  
Push ▲+▼ button at the same time for 3 seconds.
- **Exit the programming mode with saving end position:**  
Press Up button ▲ for storing the end limit and leaving the programming mode.  
=> Motor turns, stops briefly, then continuous to turn in the Up direction.  
The stop indicates that you have left the programming mode.

## 13. Technical data

Power supply	220-240 V / 50 Hz
Product class	II
International protection rating	IP54
Maximum load	250 VAC / 3 A
Output delay	180 s.
Frequency	432,42 MHz
Operating temperature	-30°C / 70°C
Number of programmable RTS sensors on 1 receiver	3 max.
Number of programmable RTS remote controls on 1 receiver	12 max.

## 14. Wiring

EN

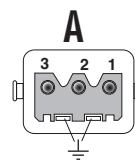
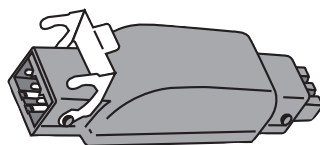
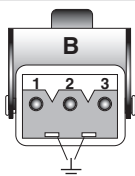

1	Blue	Neutral
2	Black	Live
3	-	-
⏚	Green/yellow	Earth

1	Blue	Neutral
2	Black	Up
3	Brown	Down
⏚	Green/yellow	Earth

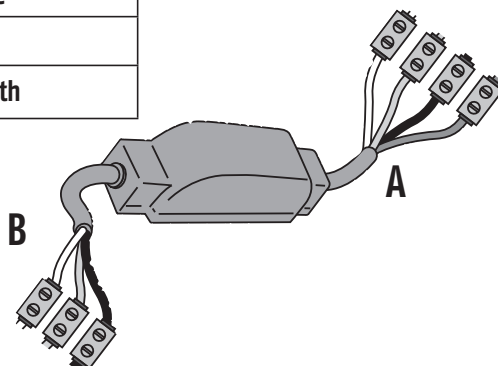

## 15. Repairs

Symptom	Action	Description
No functionality	Check	the motor
		the power supply
		the RTS remote control battery (only RTS remote controls are compatible)
		the RTS remote control programming
		radio interference
Incorrect orientation of the slats	See	Section 10 (ergonomic settings)
Lost in the settings?	See	Section 7 (restoring factory settings)