

### Resetting io motor memory

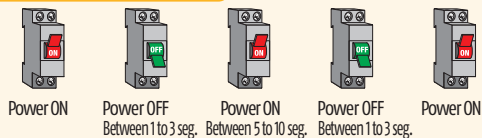

*Should be a long shutter movement*

### External Auto-scan (2W control)

Find  
(external auto-scan)



Select motor



Confirm selection  
until the green led light



*Waiting until clack-clack ...clack-clack (4º clack)*

### Resetting 2W control

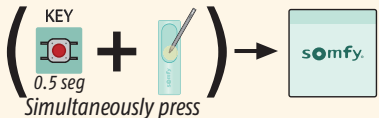

Briefly press (0.5 seg)

Long press (3 seg)

Press until the green led light

**Caption**

### Resetting sensors and Sensor Box



© Somfy España, S.A. October 2013

### Program

2W control

Power On



Find  
(External auto-scan)



Select motor



Confirm selection  
Until green led light



1W control

Identify

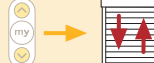

*Check direction*

Change  
direction



To the lower  
end limit



Setting  
flat slats  
(Horizontal slats)



To the upper  
end limit



Confirm

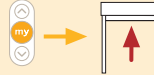

Close  
Program

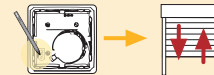

## Adding transmitter 2w

### ⚠ Transferring Key

Existing transmitter



Transmitter to be added



### ⚠ Adding transmitter

Press "PROG" button  
On the existing transmitter



Select motor



Confirm selection  
Until green led light



Press "PROG" button  
On the transmitter to be added



Briefly press (0.5 seg)

Long press (3 seg)

Press until the green led light

## Caption

## Internal auto-scan

Press "PROG" button  
3 seg. (clack-clack)

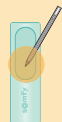

Select motor



Confirm selection  
Until green led light



Modify the end limits

Place the product at the upper or lower end limit



Setting mode  
clack-clack



Adjust the position



Set new position

clack-clack

New end limit

Change the rotation direction

Place the product halfway end limits



Setting mode

clack-clack



Set new rotation

clack-clack

New rotation direction

## Easy Sun

Adding the sun sensor



Connect

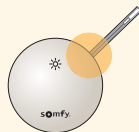

2 seg

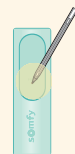

0.5 seg

Adjusting the sun sensitivity

SET



0.5 seg

Select type of application



Set the threshold

SET



7 seg

Group editing

SET

123

2 seg

SET

123

0.5 seg

Checked

SET

123

0.5 seg

Unchecked

Exit

SET

123

7 seg

## FeedBack Easy Sun



Wind



Low battery



Thermal Protection



Obstacle



Local



Radio